



Distributed by The Artistry Group Limited
THE

ARTISTRY

Shop 302, Third Floor, Landmark Atrium,
15 Queen's Road Central, Hong Kong.

info@theartistry.com.hk

Manufactured by Senbitec



2F,46-24,LS-ro 91beon-gil, Dongan-gu, Anyang-si, Gyeonggi-do, Korea

Tel : +82-70-4012-4283
www.senbitec.com

DÉCÈSSÉ PREMIUM
USER MANUAL





Contents

1. Cautions	3
2. Components	9
3. Controller	10
4. Instructions for use	11
Deesse operation	11
Sound setting	12
5. Modes	12
6. Specifications	14



CAUTIONS

-  **Warning** : warning indicates safety requirements that may result in death or serious injuries, if not followed properly.
-  **Caution** : caution indicates hazardous situations that may result in injuries or product damage.

Warning Safety requirements for the use

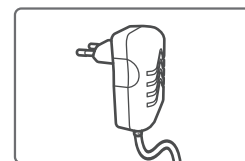

Use the exclusive power cord and adapter.

Failure to use the exclusive power cord and adapter may result in product damage, electric shock, and fire.

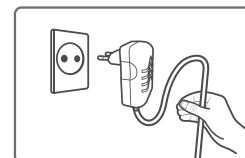

To disconnect the power cord, pull it out by the adapter. Do not drag the cord itself.

Damage in the power cord may result in electric shock, fire, or injuries.

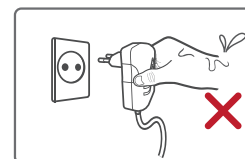

Do not connect or disconnect the power cord as well as the product itself with wet hands.

It may result in electric shock or injuries.

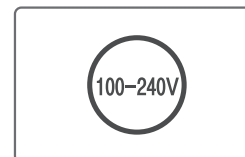

The power supply of this adapter is 100-240v.

Inappropriate usage may result in electric shock or injuries.

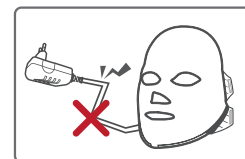

Make sure that the power cable is not entangled and do not leave any stuff on top.

It may cause fire.

⚠ Warning Safety requirements for the use

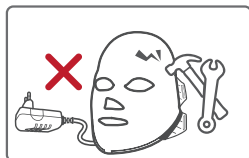

Do not intentionally modify or change the power cable.

It may cause damage, electric shock, or fire.

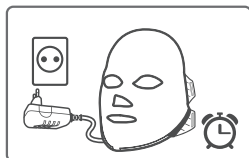

Unplug the power cable if not in use for a long time.

It may cause electrical fire due to short circuits.



Do not place the device on the unstable areas.

It may drop and cause malfunctioning or deformation.

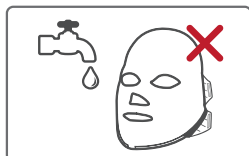

In case of any contact with high levels of moisture or water, unplug at the mains immediately.

Operating it wet may cause damage, electric shock, and injuries.

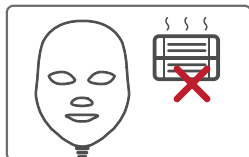

Do not place the product nearby a heater or a thermal device.

It may cause changes in color/form or fire.



Do not unplug the power cable or mask cable during the operation.

It may cause damage.



Do not place the product near the combustible materials (spray, oil, gas, etc).

It may cause explosion or fire.

⚠ Warning Safety requirements for the use

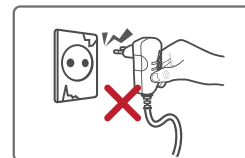

Do not connect the power cable to any loose sockets.

It may cause electric shock or fire.

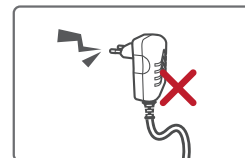

If any damages in power cable found, stop using and contact place of purchase.

It may cause electric shock, short circuit, and fire.

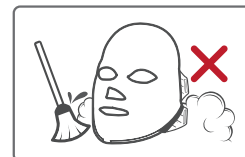

Avoid any areas with dust or water.

It may cause electric shock or fire.

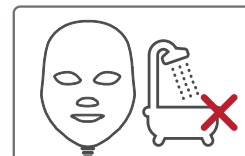

Do not use in places with water contact such as sauna, shower, swimming pool etc.

It may cause electric shock or fire.



If any strange sound, smoke, or smell is detected from the product, immediately unplug and contact place of purchase. Do not disassemble the product randomly.

It may cause electric shock or fire.

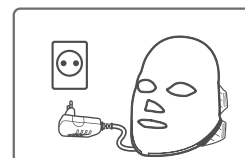

Unplug the power cable first before wiping out the product.

It may cause electric shock.

⚠ Caution Safety requirements for the use



Avoid any severe shock on the product.
It may cause damage.

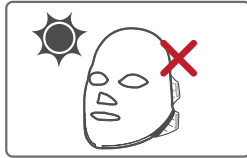

Store away from direct sunlight or heat.
It may cause damage.

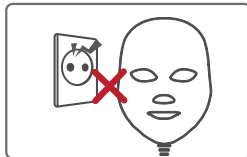

Do not use in areas with unstable voltage.
It may cause damage.

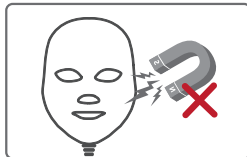

Do not place any magnet nearby the product.
It may cause malfunctioning.



For cleansing, do not spray any water or volatile materials but gently wipe out with a dry cloth.
Using benzene, thinner, etc may result in product damage.

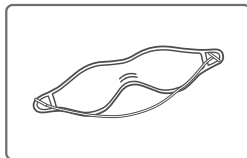

Wear eye guard before placing the mask on face.

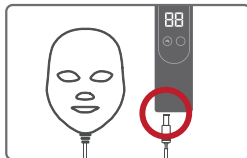

Connect the mask cable first before turning on the power.

⚠ Caution Safety requirements for the use

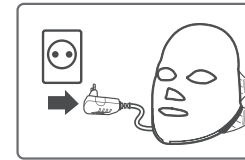

Do not use the product for purposes other than facial skin care.



If you have taken any light-sensitive medications or cosmetics, do not use.
It may cause hot flush or pigmentation.



Do not use the product if you were exposed to the sunlight for a long time from outdoor activities.

- Read the user manual thoroughly before use.
- Recommended to use for 10 minutes and try not to use for more than 30 minutes per application.
- Place the mask on face first before starting the operation and you may experience dazzling due to LED light exposure.
- Do not look directly at the LED light when it is in operation.
- Do not use if you have any tingling or irritation from tanning.
- Do not use for patients with diabetes or any skin problems from disease.
- Do not use for patients who had radiation treatment or chemotherapy for recent 3 months.
- Do not use for patients with any skin disease such as skin cancer.
- Freckles may become more visible from the toning effect after the use.
- Too much application of 415nm (blue) may cause pigmentation depending on the skin condition. Recommended time for use is 10 minutes per application

Caution Safety requirements for the use



Consult your doctor

• Before application

- If you are having a skin treatment or using photosensitizer.
- If you had decortication.
- Avoid using acne medication (such as Accutane), whitening treatment, Retin A ointment, or any cosmetics containing retinol from 7 days before use.

• During application

- If any of the following symptoms appear, decrease the intensity or number of applications; red spots appearing on surface or soring.
- Consult your doctor if any of these symptoms continue.
- Consult your doctor immediately if any of blisters or burning appear. In case of pigmentation, stop the use immediately. This symptom will disappear in 1~2 weeks. If the symptom continues, please consult your doctor.
- When applying the product after pigmentation, reduce the number of applications or time duration.

Storage



Store away from direct sunlight or areas with high temperature and humidity.



Keep the contact surface of mask clean after each use.



When cleaning, wipe it out with a soft dry cloth.



Store it safely, away from a strong impact or pressure which may result in the damage.



Keep it out of reach of children.

COMPONENTS

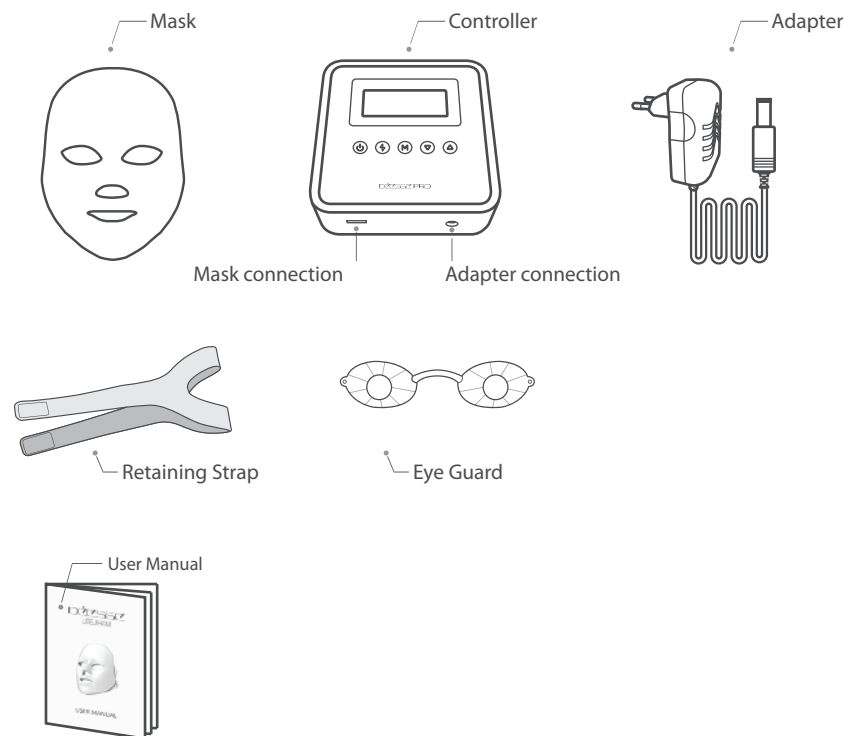

* The images may look different from the actual products.

CONTROLLER

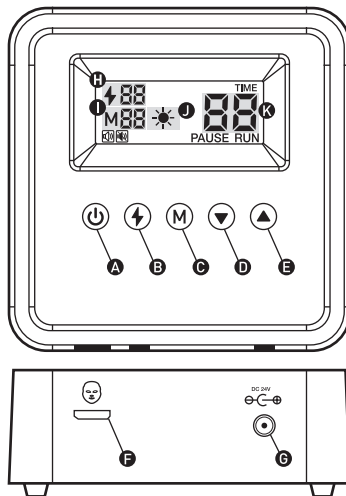

A Power On/Off, Start, Pause

Press the button for 2~3 seconds to turn on/off the power.
Set the mode first and press the button shortly to start the operation.
If you wish to pause the operation, press the button shortly.

B Intensity Control

Press to select the intensity of light.
The intensity will change from 1 to 2 each time you press the button.

C Mode setting

Press the button to set the mode.
It will change from M01 to M08 each time you press the button.

D / E Time Control

Press **D**/**E** button to change the time in 5-minute interval.
(except Mode 7 and 8)

F Mask Cable

Connect the cable from the mask into **F**.

G Power Cable

Connector for adapter.

H Intensity Control Display

Shows intensity of the light.

I LED Display

Shows the mode of operation.

J Action Display

Lighted when the product is in operation.

K Operation Time

Shows the time set before operation and remaining time during operation.

INSTRUCTIONS FOR USE



1. Deesse operation

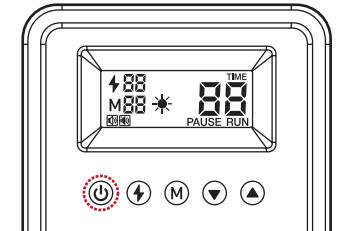

- 1) Gently wipe out the mask clean before use.
- 2) Connect the power cable to the controller.
- 3) Connect the mask cable to the controller.
- 4) Put on the eye guard and then, the mask.
Adjust the strap to make sure that the mask is placed properly on your face.
- 5) Press the power button  for 2~3 seconds to turn on the device.

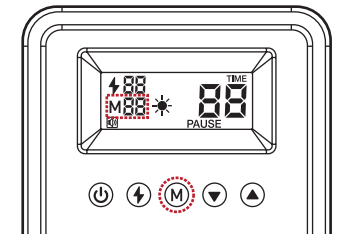

- 6) Press **M** button to set the mode. The mode will change each time you press the button and shown on the LCD display. (Mode 1 to Mode 8)



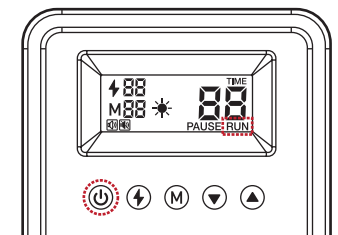

- 7) Set the time for each mode by pressing the Up/Down button. 
Changes in 5-minute interval and up to 60 minutes.
Recommended time for each mode is 15 minutes per application.
For Mode 7 and 8, the time is set to 15minutes and will turn off automatically once the time is up.
- 8) If you wish to adjust light intensity, press  button.

- 9) After setting mode and time, press the power button  shortly to start the operation. Then "RUN" will appear on the LCD screen.
- 10) The controller will turn off automatically once the time is up.
- 11) If you wish to pause, press the power button  shortly



※ If kept in pause for more than 10 minutes, it will turn off automatically.

2. Sound setting

1) If you wish to turn off the sound, press the power button  and intensity control button  at the same time.

 Sound

 Mute

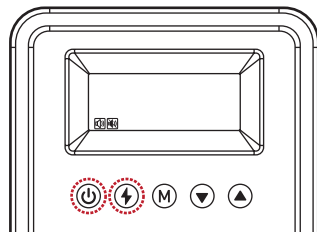

MODES

Mode 1 Signs of aging

Helps diminish signs of aging.

Mode 2 Excess oil care

Helps balance shiny and oily skin.

Mode 3 Sensitive skin care

Helps soothe skin sensitivity.

Mode 4 Toning care

Brightens and evens out skin tone.

Mode 5 Total care 1

Multi-care function with wrinkle, excess oil, and Infrared ray (IR) care.

Mode 6 Total care 2

Combination of Mode 1 and Mode 3 with infrared ray (IR).

Mode 7 Total care 3

Combination of Mode 2 and Mode 4 with infrared ray (IR).

Mode 8 IBlemish-prone skin care

Helps soothe and comfort blemish-prone skin.

Mode M01



Red(630nm) + IR(830nm)

Recommended time 15mins , Maximum setting 30mins

Mode M02



Blue(415nm) + IR(830nm)

Recommended time 10mins , Fixed time 10mins

Mode M03



Yellow(580nm) + IR(830nm)

Recommended time 15mins , Maximum setting 30mins

Mode M04



Green(520nm) + IR(830nm)

Recommended time 15mins , Maximum setting 30mins

Mode M05



Red(630nm) + Blue(415nm) + IR(830nm)

Red + Blue (3mins) > Red + IR (1mins) > Blue + IR (1mins)

Recommended time 15mins , Maximum setting 30mins

Mode M06



Red(630nm) + Yellow(580nm) + IR(830nm)

Red + Yellow (3mins) > Red + IR (1mins) > Yellow + IR (1mins)

Recommended time 15mins , Maximum setting 30mins

Mode M07



Red(630nm) + Green(520nm) + IR(830nm)

Red + Green (3mins) > Red + IR (1mins) > Green + IR (1mins)

Recommended time 15mins , Maximum setting 30mins

Mode M08



Blue(415nm) + Green(520nm) + IR(830nm)

Blue + Green (3mins) > Blue + IR (1mins) > Green + IR (1mins)

Recommended time 10mins , Fixed time 10mins



SPECIFICATIONS

Product name	DEESSE PREMIUM LED MASK
Model name	SBT-MLLT-PM
Voltage	DC24V/1A
Power consumption	20W
LED wavelength	415nm(Blue), 630nm(Red), 830nm(IR), 580nm(Yellow) 520nm(Green)
Manufacturer	Senbitec Co.,Ltd
Origin	Korea
Address	2F, 46-24, LS-ro 91beongil, Dongan-gu, Anyang-si, Gyeonggido

Rev. 18-002

DEESSE PREMIUM

Product Warranty Terms



The Artistry's top priorities are safety, quality and efficacy. We have total confidence in the uncompromising reliability of our products hence you can receive 10 years warranty.

1. These warranty terms and conditions will apply in the country in which the sale is made, provided the order has been properly placed with The Artistry Group Limited.
2. The Artistry provides an extended warranty of 10 years on Deesse Premium Pro from their date of purchase. From years 1 to 3, Repair work at the factory will be free of charge and covered by The Artistry. End-user is responsible for all shipping costs. From years 4 to 10, The Artistry will continue to provide Warranty on the control panel and LED face mask free of charge, excluding parts subject to wear. For the execution of warranty repairs, an additional cost will be charged to cover labour, plus a fixed charge to cover any traveling costs, where applicable.
3. The Artistry warranty does not cover: a) changes and damage caused by use of the product for anything other than its intended purpose. Nor does the warranty cover damage caused through inappropriate treatment, or damage that arises through unusual environmental effects (extreme weather conditions, acid, moisture etc.). b) damage caused through maintenance or repair work by the customer or by third parties; c) damage that occurs during transportation;
4. In the event of claims: you will be asked to provide description of the damage or defect, model name, order confirmation number or invoice if applicable. The Artistry may refuse to process the claim if such information are not provided.

